

BOSE[®]



COMPANION[®] 20

MULTIMEDIA SPEAKER SYSTEM

Owner's Guide | Guía de usuario | Notice d'utilisation

Safety and Regulatory Information

Please read this owner's guide

Please take the time to follow the instructions in this owner's guide carefully. It will help you set up and operate your system properly and enjoy its advanced features. Please save this owner's guide for future reference.

WARNING: *To reduce the risk of fire or electrical shock, do not expose the product to rain or moisture.*

WARNING: *Do not expose this apparatus to dripping or splashing, and do not place objects filled with liquids, such as vases, on or near the apparatus. As with any electronic products, use care not to spill liquids into any part of the system. Liquids can cause a failure and/or a fire hazard.*

	CAUTION RISK OF ELECTRICAL SHOCK DO NOT OPEN	
CAUTION: TO REDUCE THE RISK OF ELECTRIC SHOCK, DO NOT REMOVE COVER (OR BACK). NO USER-SERVICEABLE PARTS INSIDE. REFER SERVICING TO QUALIFIED PERSONNEL.		

	AVIS RISQUE DE CHOC ELECTRIQUE NE PAS OUVRIR	
ATTENTION : POUR RÉDUIRE LE RISQUE DE DÉCHARGE ÉLECTRIQUE, NE RETIREZ PAS LE COUVERCLE (OU L'ARRIÈRE), IL NE SE TROUVE À L'INTÉRIEUR AUCUNE PIÈCE POUVANT ÊTRE RÉPARÉE PAR L'USAGER. S'ADRESSER À UN RÉPARATEUR COMPÉTENT.		



The lightning flash with arrowhead symbol within an equilateral triangle alerts the user to the presence of uninsulated, dangerous voltage within the system enclosure that may be of sufficient magnitude to constitute a risk of electrical shock.



The exclamation point within an equilateral triangle, as marked on the system, is intended to alert the user to the presence of important operating and maintenance instructions in this owner's guide.

WARNING: *Do not place any naked flame sources, such as lighted candles, on or near the apparatus.*

SAFETY AND REGULATORY INFORMATION

CAUTION: Make no modifications to the system or accessories. Unauthorized alterations may compromise safety, regulatory compliance, and system performance.

CAUTION: Long-term exposure to loud music may cause hearing damage. It is best to avoid extreme volume when using headphones, especially for extended periods.

CAUTION: Use only the power supply provided with the speaker system.



This product conforms to all EU Directive requirements as applicable by law. The complete Declaration of Conformity can be found at www.Bose.com/static/compliance.

Names and Contents of Toxic or Hazardous Substances or Elements

Part Name	Toxic or Hazardous Substances and Elements					
	Lead (Pb)	Mercury (Hg)	Cadmium (Cd)	Hexavalent (CR(VI))	Polybrominated Biphenyl (PBB)	Polybrominated diphenylether (PBDE)
PCBs	X	0	0	0	0	0
Metal parts	X	0	0	0	0	0
Plastic parts	0	0	0	0	0	0
Speakers	X	0	0	0	0	0
Cables	X	0	0	0	0	0

O: Indicates that this toxic or hazardous substance contained in all of the homogeneous materials for this part is below the limit requirement in SJ/T 11363-2006.

X: Indicates that this toxic or hazardous substance contained in at least one of the homogeneous materials used for this part is above the limit requirement in SJ/T 11363-2006.

SAFETY AND REGULATORY INFORMATION

NOTES:

- *The product label is located on the bottom of the product.*
- *The product is intended to be used only with the power supply provided.*
- *The product must be used indoors. It is neither designed nor tested for use outdoors, in recreational vehicles, or on boats.*
- *Where the mains plug or appliance coupler is used as the disconnect device, such disconnect device shall remain readily operable.*

Additional safety information

See the additional instructions on the Important Safety Instructions sheet (North America only) enclosed in the shipping carton.

iPod is a trademark of Apple Inc., registered in the U.S. and other countries.

©2011 Bose Corporation. No part of this work may be reproduced, modified, distributed, or otherwise used without prior written permission.

SAFETY AND REGULATORY INFORMATION

Information about products that generate electrical noise

This equipment has been tested and found to comply with the limits for a Class B digital device, pursuant to Part 15 of the FCC rules. These limits are designed to provide reasonable protection against harmful interference in a residential installation. This equipment generates, uses, and can radiate radio frequency energy and, if not installed and used in accordance with the instructions, may cause harmful interference to radio communications. However, this is no guarantee that interference will not occur in a particular installation. If this equipment does cause harmful interference to radio or television reception, which can be determined by turning the equipment off and on, you are encouraged to try to correct the interference by one or more of the following measures:

- Reorient or relocate the receiving antenna.
- Increase the separation between the equipment and receiver. Connect the equipment to an outlet on a different circuit than the one to which the receiver is connected.
- Consult the dealer or an experienced technician for help.

NOTE: *Unauthorized modification of the system could void the user's authority to operate this equipment and may void the warranty.*

This product complies with the Canadian ICES-003 Class B specifications.

For future reference

For convenience, enter the serial number (S/N located on the bottom of the right speaker) below and on the Customer Warranty card.

Serial number: _____

Purchased on: _____

We suggest that you keep your purchase receipt and the limited warranty with this guide.

CONTENTS

Introduction	8
Setting Up	9
Unpacking	9
Positioning the speakers and control pod	10
Connecting	12
Connecting the cables	12
Connecting an external music source	14
Connecting headphones	14
Using the speaker system	15
Turning on the system	15
Controlling the volume	15
Automatic standby	17
Troubleshooting	17
Contacting Customer Service	19
Maintenance and Technical Information	20
Cleaning the system	20
Technical Information	20
Limited Warranty	21
What you must do to obtain limited warranty service	21

INTRODUCTION

Congratulations on your purchase of the Bose® Companion® 20 multimedia speaker system. With these high-quality speakers, you can enjoy:

- Full, natural sound from just two speakers whether sitting directly in front of your computer or across the room.
- Sleek, space-saving design that complements the look of your computer.
- A unique control pod that makes it easy to adjust or mute the volume and connect headphones and other audio devices.
- Exclusive TrueSpace® stereo digital signal processing that reproduces wide, natural sound from only two speakers, bringing more life to music, games and videos.
- Proprietary digital signal processing that delivers crisp, clear performance at all listening levels.
- Advanced port design and driver that produce powerful low note performance and room-filling sound.

SETTING UP

Unpacking

During unpacking, make sure that all parts shown are in the carton. If any part is missing or damaged, contact your Bose dealer. Save the carton and all packing materials for possible future use.

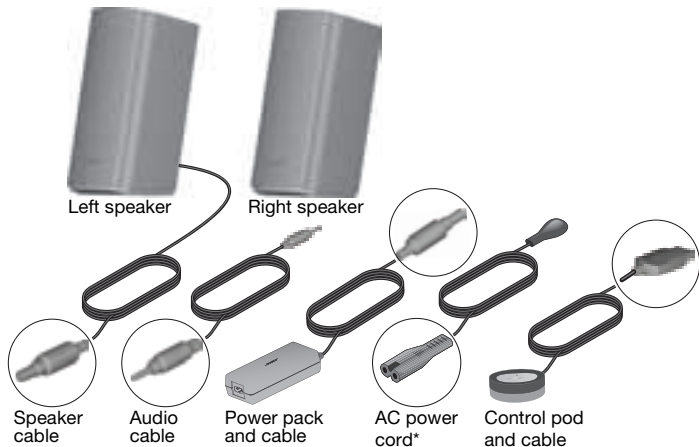

**Correct for your region.*

Positioning the speakers and control pod

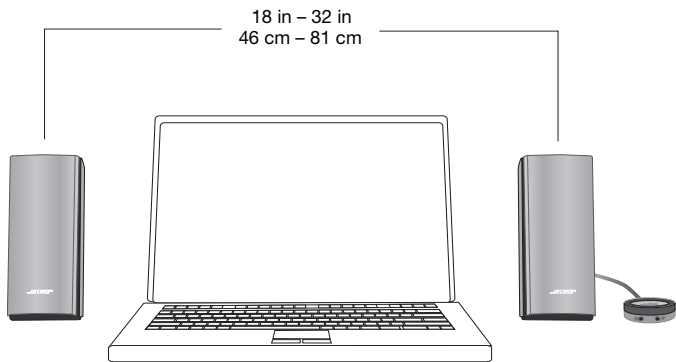

The size and shape of these speakers make it easy to position them directly next to your computer. To provide an accurate sound stage, you should observe the following guidelines:

- Place the left and right speakers (left and right speakers are identified on each speaker back panel) an equal distance from

SETTING UP

the center of your computer monitor or screen. They should be between 18 and 32 inches apart.

- Avoid putting objects directly in front of the lower part of the speaker grilles. This area is where the speaker driver is located.
- Do not place the speakers too far behind your computer monitor or screen because that will block the sound.
- Place the control pod so it is within easy reach.
- Keep the front of the speakers even with, or slightly forward of, the front of the computer screen.

CONNECTING

Connecting the cables

Use the four provided cables and the AC power cord to make the connections shown on page 13.

CAUTION: *Do not plug in the AC power cord until all other connections are completed.*

1. Insert one end of the audio in cable (a) into the **Audio In** connector on the back of the right speaker.
2. Insert the other end of the cable into the **Headphone or Speaker output** connector (the labels and positions of these connectors vary) on your computer.
3. Insert the control pod cable (b) plug into the **Control Pod** connector on the right speaker.
4. Insert the free end of the DC power cable (c) into the **DC Power** connector on the right speaker.
5. Insert the end of the left speaker cable (d) into the **Left Speaker** connector on the right speaker.
6. Insert the small end of the AC power cord (e) into the power pack and then insert the large end into an AC (mains) outlet.

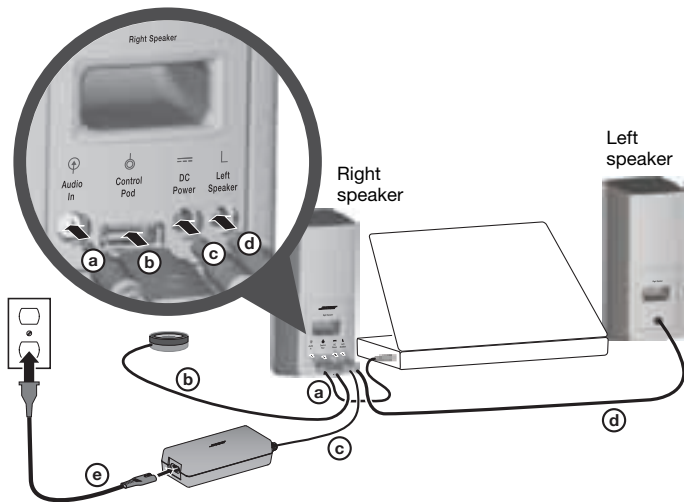
CONNECTING

Connecting an external music source

You can connect an iPod, mp3 player, or other music source to the control pod using a 3.5 mm plug (not supplied). The music source audio and computer audio are mixed and will both play at the same time.

To connect an external music source

Fully insert the 3.5 mm plug from the music source into the Audio In connector on the control pod. To avoid hearing both the computer and external music source, mute the computer audio.

Connecting headphones

Use headphones with a 3.5 mm plug. Fully insert the 3.5 mm plug into the headphone connector on the control pod. Connecting headphones to the Companion[®] 20 system mutes the sound from the speakers.



USING THE SPEAKER SYSTEM

Turning on the system

Touch the top of the control pod to turn the speaker system on. The power indicator illuminates. Touch the top of the control pod again to turn the system off. The power indicator extinguishes.

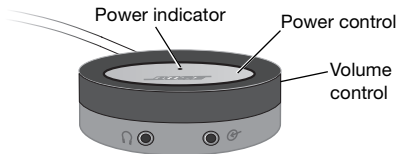

Controlling the volume

Rotate the volume control (top outer band) on the control pod clockwise to increase the volume; counterclockwise to decrease volume.

When your sound source has a volume control

1. Rotate the Companion® 20 control pod volume control fully counterclockwise to decrease the volume to minimum (zero).
2. Adjust the volume on your sound source to *near* maximum. As you increase the volume, no sound is emitted from the Companion® 20 speakers, because they are set to minimum.

USING THE SPEAKER SYSTEM

Note: *You should never turn your sound source up to maximum volume, as this could cause the sound to distort. A volume setting of about 80% of maximum should be sufficient.*

3. Rotate the Companion® 20 control pod volume control clockwise until the sound reaches the desired listening level.

Automatic standby

The Companion® 20 system automatically goes into the standby state after two hours when there is no audio signal or the volume is turned all the way down. You can disable automatic standby so the system is always on when connected to power.

To disable automatic standby

Lightly press and hold the top of the control pod (approximately six seconds) until you hear two tones that chime from high to low.

To re-enable automatic standby

Lightly press and hold the top of the control pod again until you hear two tones that chime from low to high.

TROUBLESHOOTING

Low volume settings (less than $\frac{2}{3}$ maximum) on your computer or media player reduce its output and can unnecessarily limit the volume of the Companion® 20 system.

Computer volume controls often include:

- External buttons, which may operate independent of the onscreen controls.
- Onscreen controls, provided on the computer.
- Various media player controls.

Try adjusting one or more of these controls if the sound from the Companion® 20 system is too low.

TROUBLESHOOTING

Problem	What to do
No sound	<ul style="list-style-type: none">• Make sure the speakers are turned on (the power indicator on the control pod is illuminated).• Make sure the control pod volume control is not turned fully counterclockwise (minimum).• Make sure the computer is plugged in and turned on, mute is turned off, and all volume controls are turned up.• Be sure the power pack is securely plugged into the right speaker and into a power outlet or surge protector.• Be sure the AC power outlet is working. When using a surge protector or power strip, be sure it is turned on.
The Companion® 20 system sound seems distorted	Decrease the volume of the sound source and increase the Companion® 20 speaker volume using the control pod.

TROUBLESHOOTING

Problem	What to do
One speaker does not play or sounds distorted	<ul style="list-style-type: none"> • Make sure the cable from the left speaker is firmly inserted into the Left Speaker connector on the back of the right speaker. • Check the balance setting on your sound source.
Cannot control the volume using the control pod	<p>Make sure the control pod plug is fully inserted into the connector on the rear of the right speaker. Push the plug in using sufficient force to ensure that it is fully inserted into the connector.</p>
No sound from headphones	
No sound from the connected device	

Contacting Customer Service

For additional help in solving problems, contact Bose® Customer Service. Refer to the address sheet included in the carton, or visit <http://global.Bose.com>

MAINTENANCE AND TECHNICAL INFORMATION

Cleaning the system

Wipe the speakers and control pod with a dry cloth.

- Do not use solvents or chemicals.
- Do not allow liquids or objects to enter the rear port of the speakers, the speaker grilles, or any part of the control pod.

If the bottom of the control pod loses its adhesion to the tabletop, use a lint-free cloth, slightly dampened with water, to clean the control pod bottom surface.

Technical Information

Driver complement

Two 2.75 inch (70 mm) high excursion, wide-range transducers

Dimensions (approximate)

Speakers: 8.6"H x 3.5"W x 4.4"D (22.0 cm x 9.0 cm x 15.0 cm)

Control pod: 2.5"D x 1.125"H (6.3 cm x 2.8 cm)

Weight (approximate)

One speaker, unpacked: 2.5 lb (1.1 kg)

Control pod: 0.5 lb (0.2 kg)

LIMITED WARRANTY

This system is covered by a limited warranty. Details of the limited warranty are provided on the Product Registration Card that came with your system. Please fill out the information section on the card and mail it to Bose. Failure to do so, however, will not affect your limited warranty rights.

What you must do to obtain limited warranty service

Return the product, with proof of purchase from an authorized Bose dealer, using the following procedures:

- 1.** Contact the Bose organization in your country or region (visit <http://global.Bose.com> for Bose contact information in your country or region) for specific return and shipping instructions.
- 2.** Label and ship the product, freight prepaid, to the address provided by the Bose organization in your country.
- 3.** Place any necessary return authorization number prominently on the outside of the carton. Cartons not bearing a return authorization number where required, will be refused.



344837-0010

BOSE[®]
Better sound through research[®]

©2011 Bose Corporation, The Mountain,
Framingham, MA 01701-9168 USA
AM344837 Rev.02