

VICTOR BAILEY JAZZ BASS 0196800

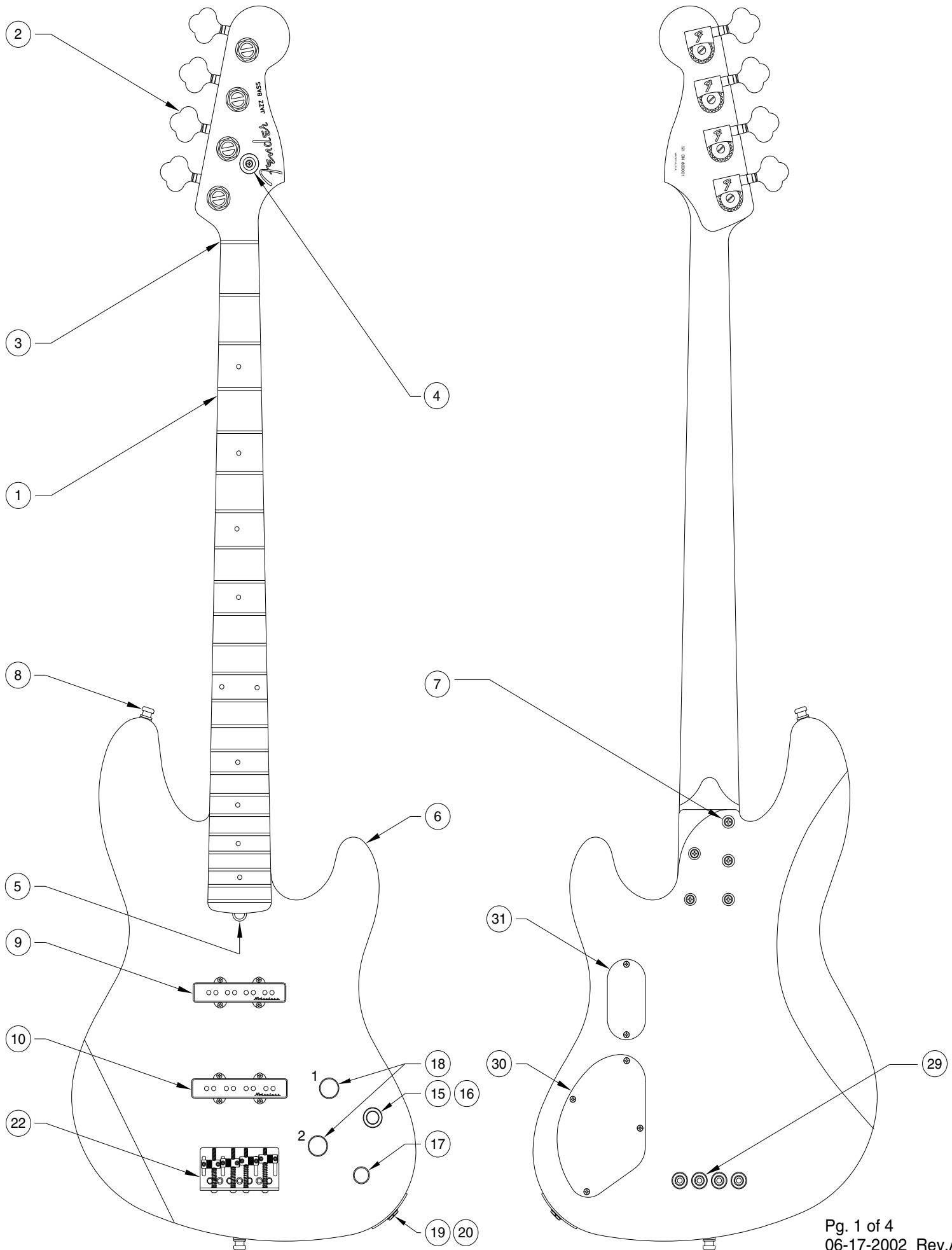

WIRE DIAGRAM

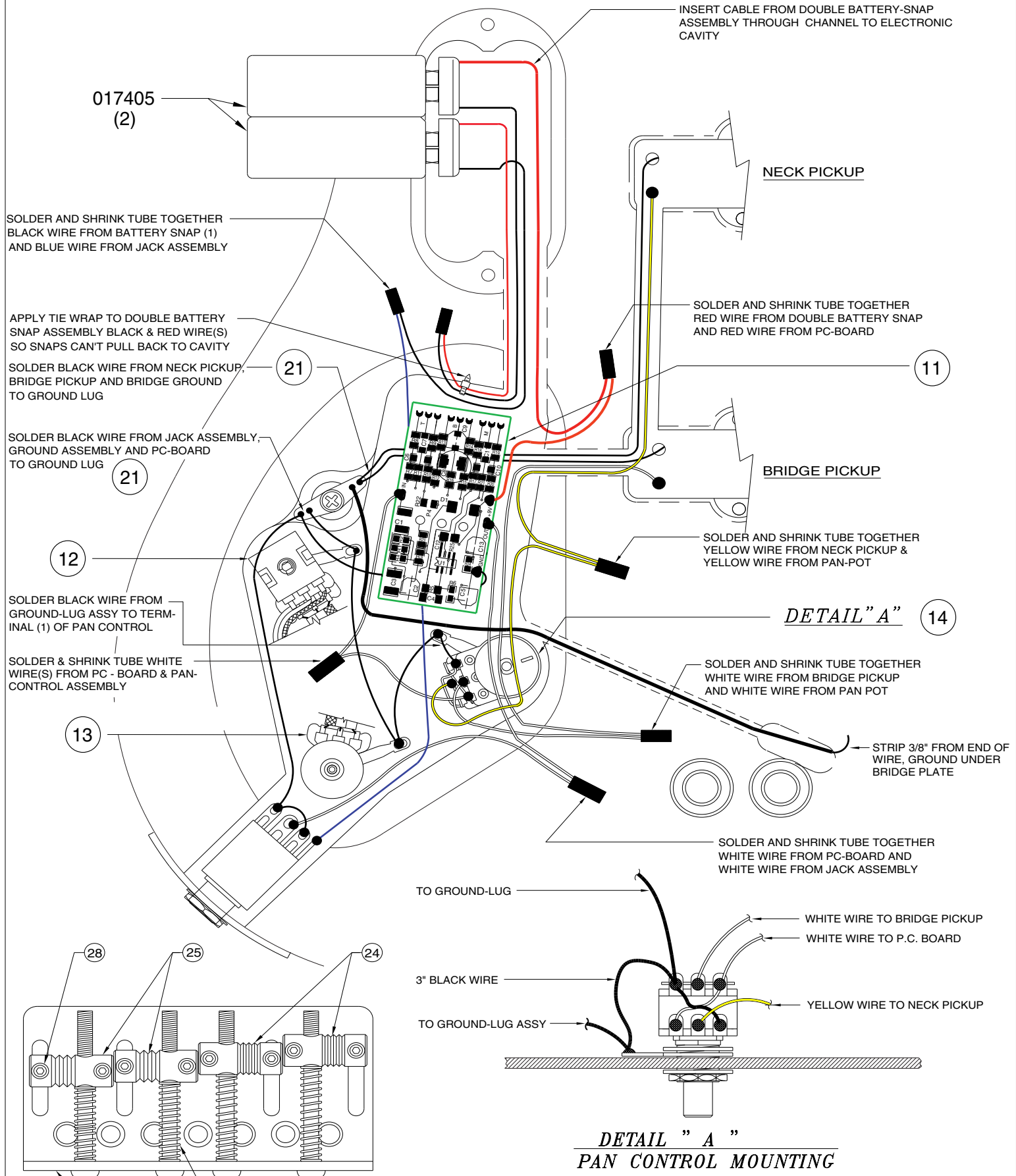

017405  
(2)

INSERT CABLE FROM DOUBLE BATTERY-SNAP ASSEMBLY THROUGH CHANNEL TO ELECTRONIC CAVITY

NECK PICKUP

SOLDER AND SHRINK TUBE TOGETHER BLACK WIRE FROM BATTERY SNAP (1) AND BLUE WIRE FROM JACK ASSEMBLY

SOLDER AND SHRINK TUBE TOGETHER RED WIRE FROM DOUBLE BATTERY SNAP AND RED WIRE FROM PC-BOARD

APPLY TIE WRAP TO DOUBLE BATTERY SNAP ASSEMBLY BLACK & RED WIRE(S) SO SNAPS CAN'T PULL BACK TO CAVITY

SOLDER BLACK WIRE FROM NECK PICKUP, BRIDGE PICKUP AND BRIDGE GROUND TO GROUND LUG

SOLDER BLACK WIRE FROM JACK ASSEMBLY, GROUND ASSEMBLY AND PC-BOARD TO GROUND LUG

SOLDER BLACK WIRE FROM GROUND-LUG ASSY TO TERMINAL (1) OF PAN CONTROL

SOLDER & SHRINK TUBE WHITE WIRE(S) FROM PC - BOARD & PAN-CONTROL ASSEMBLY

SOLDER AND SHRINK TUBE TOGETHER YELLOW WIRE FROM NECK PICKUP & YELLOW WIRE FROM PAN-POT

SOLDER AND SHRINK TUBE TOGETHER WHITE WIRE FROM BRIDGE PICKUP AND WHITE WIRE FROM PAN POT

STRIP 3/8" FROM END OF WIRE, GROUND UNDER BRIDGE PLATE

SOLDER AND SHRINK TUBE TOGETHER WHITE WIRE FROM PC-BOARD AND WHITE WIRE FROM JACK ASSEMBLY

TO GROUND-LUG

WHITE WIRE TO BRIDGE PICKUP  
WHITE WIRE TO P.C. BOARD

3" BLACK WIRE

YELLOW WIRE TO NECK PICKUP

TO GROUND-LUG ASSY

DETAIL " A " PAN CONTROL MOUNTING

BRIDGE ASSEMBLY

## VICTOR BAILEY JAZZ BASS 0196800

REF.#	P/N	DESCRIPTION	REF.#	P/N	DESCRIPTION
1	0058666000	Neck, Victor Bailey Jazz Bass, R/W	24	0058362000	Bridge Section, (1&2)
2	0058216000	Tuning Key, (1) Set	25	0058253000	Bridge Section, (3&4)
3	0048649000	Bone Nut	26	0017571000	Intonation Screw, (4)
4	0021958000	String Retainer	27	0018872000	Intonation Spring, (4)
	0018784000	Mounting Screw	28	0021093000	Height Adjustment Screw, (8)
5	0048688000	Truss Rod Adjustment Nut		0021109000	Adjusting Wrench, Saddle Height
	0048693000	Truss Rod Adjusting Wrench	29	0049763000	Ferrule, String Retainer
6	0058665xxx	Body, Victor Bailey Jazz Bass, Paint	30	0058206000	Battery Cover
7	0058415000	Neck Ferrule		0018113000	Mounting Screw
	0018785000	Mounting Screw	31	0058410000	Cover, Double Battery
8	0021950000	Strap Button		0030654000	Mounting Screw
	0018845000	Mounting Screw		0030688000	Inserting Screw
	0019056000	Felt Washer, Black		0017405000	Battery, 9 Volt
9	0058244000	Pickup, Neck, Deluxe Jazz Bass			
	0018847000	Mounting Screw			
	0055195000	Cover, Pickup, W/Logo			
	0017333000	Weatherstrip, Rubber			
10	0058245000	Pickup, Bridge, Deluxe Jazz Bass			
	0018847000	Mounting Screw			
	0055194000	Cover, Pickup, W/Logo			
	0017333000	Weatherstrip, Rubbber			
11	0058227000	Printed Circuit Board Ass'y			
	0056161000	Control, 25KB, Audio			
	0018824000	Mounting Hex Nut			
	0022384000	Lock Washer, Intl			
	0018806000	Flat Washer			
12	0058338000	Control, 100KB, Tocos CN DTNT			
	0018824000	Mounting Screw			
	0018806000	Flat Washer			
13	0056160000	Control, 100KB, CNTR, CTS			
	0058793000	Mounting Hex Nut			
	0058792000	Washer Dress			
14	0056162000	Control, 250K, Pan Alpha			
	0018824000	Mounting Hex Nut			
	0036811000	Knob, #2, Page (2), Knurled, Burton Gold			
	0031153000	Flat Washer			
	0018806000	Flat Washer			
15	0058337000	Knob, Lower, Knurled, Gold			
	0028897000	Set Screw			
16	0058336000	Knob, Upper, Knurled, Gold			
	0058786000	Set Screw			
17	0058335000	Knob, Small, Knurled, Gold			
	0028897000	Set Screw			
18	0036811000	Knob, Knurled, Burton Gold, (2)			
	0028897000	Set Screw			
19	0058251000	Output Jack			
	0018824000	Mounting Hex Nut			
	0016436000	Washer Lock, Intl			
	0018806000	Washer, Flat			
20	0058256000	Ferrule, Jack			
	0018784000	Mounting Screw			
21	0012869000	Solder Lug, (2)			
	0015116000	Mounting Screw			
22	0058252000	Bridge Assembly			
	0018845000	Mounting Screw			
23	0058270000	Bridge Plate			

Body Part Number	
0058665521	Natural

CONTROL FUNCTION

