

Stereo Cassette Tape Deck **K-501A**

Before using

Connections

Operation

Other Information

Instruction Manual

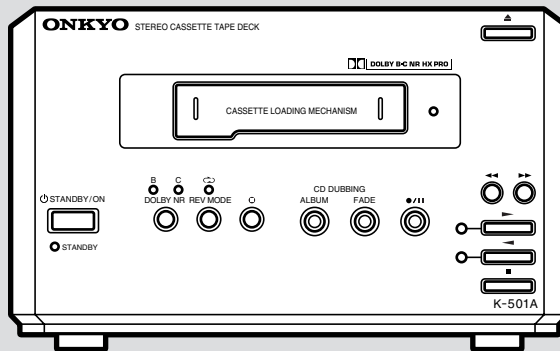

Before using
Thank you for purchasing ...

Thank you for purchasing Onkyo K-501A Stereo Cassette Tape Deck.
 Please read this manual thoroughly before making connections and plugging in the unit.
 Following the instructions in this manual will enable you to obtain optimum performance and listening enjoyment from your new K-501A.
 Please retain this manual for future reference.

Main Features

- **A compact, discrete component with 155mm (6-1/8") wide**
- **Dolby* B NR and Dolby C NR systems that reduce tape background hiss**
- **Dolby HX Pro system that expands the dynamic range in higher frequencies and constantly adjusts recording conditions**

Declaration of Conformity

We, ONKYO EUROPE ELECTRONICS GmbH
 INDUSTRIESTRASSE 20
 82110 GERMERING,
 GERMANY



declare in own responsibility, that the ONKYO product described in this instruction manual is in compliance with the corresponding technical standards such as EN60065, EN55013, EN55020 and EN61000-3-2, -3-3.

GERMERING, GERMANY



ONKYO EUROPE ELECTRONICS GmbH

*Dolby noise reduction and HX Pro headroom extension manufactured under license from Dolby Laboratories Licensing Corporation. HX Pro originated by Bang and Olufsen.

"Dolby," the double-D symbol and "HX Pro" are trademarks of Dolby Laboratories Licensing Corporation.

WARNING:

TO REDUCE THE RISK OF FIRE OR ELECTRIC SHOCK, DO NOT EXPOSE THIS APPLIANCE TO RAIN OR MOISTURE.

CAUTION:

TO REDUCE THE RISK OF ELECTRIC SHOCK, DO NOT REMOVE COVER (OR BACK). NO USER-SERVICEABLE PARTS INSIDE. REFER SERVICING TO QUALIFIED SERVICE PERSONNEL.



The lightning flash with arrowhead symbol, within an equilateral triangle, is intended to alert the user to the presence of uninsulated "dangerous voltage" within the product's enclosure that may be of sufficient magnitude to constitute a risk of electric shock to persons.

The exclamation point within an equilateral triangle is intended to alert the user to the presence of important operating and maintenance (servicing) instructions in the literature accompanying the appliance.

Important Safeguards

1. **Read Instructions** – All the safety and operating instructions should be read before the appliance is operated.
2. **Retain Instructions** – The safety and operating instructions should be retained for future reference.
3. **Heed Warnings** – All warnings on the appliance and in the operating instructions should be adhered to.
4. **Follow Instructions** – All operating and use instructions should be followed.
5. **Water and Moisture** – The appliance should not be used near water – for example, near a bathtub, washbowl, kitchen sink, laundry tub, in a wet basement, or near a swimming pool, and the like.
6. **Carts and Stands** – The appliance should be used only with a cart or stand that is recommended by the manufacturer.
- 6A. An appliance and cart combination should be moved with care. Quick stops, excessive force, and uneven surfaces may cause the appliance and cart combination to overturn.
7. **Wall or Ceiling Mounting** – The appliance should be mounted to a wall or ceiling only as recommended by the manufacturer.
8. **Ventilation** – The appliance should be situated so that its location or position does not interfere with its proper ventilation. For example, the appliance should not be situated on a bed, sofa, rug, or similar surface that may block the ventilation openings; or if placed in a built-in installation, such as a bookcase or cabinet that may impede the flow of air through the ventilation openings, there should be at least 5 cm (2 in.) of free space behind the appliance.
9. **Heat** – The appliance should be situated away from heat sources such as radiators, heat registers, stoves, or other appliances (including amplifiers) that produce heat.
10. **Power Sources** – The appliance should be connected to a power supply only of the type described in the operating instructions or as marked on the appliance.
11. **Polarization** – If the appliance is provided with a polarized plug having one blade wider than the other, please read the following information: The polarization of the plug is a safety feature. The polarized plug will only fit the outlet one way. If the plug does not fit fully into the outlet, try reversing it. If there is still trouble, the user should seek the services of a qualified electrician. Under no circumstances should the user attempt to defeat the polarization of the plug.
12. **Power-Cord Protection** – Power-supply cords should be routed so that they are not likely to be walked on or pinched by items placed upon or against them, paying particular attention to the cords at plugs, convenience receptacles, and the point where they exit from the appliance.
13. **Cleaning** – The appliance should be cleaned only as recommended by the manufacturer.
14. **Nonuse Periods** – The power cord of the appliance should be unplugged from the outlet when left unused for a long period of time.
15. **Object and Liquid Entry** – Care should be taken so that objects do not fall and liquids are not spilled into the enclosure through openings.
16. **Damage Requiring Service** – The appliance should be serviced by qualified service personnel when:
 - A. The power-supply cord or the plug has been damaged; or
 - B. Objects have fallen or liquid has been spilled into the appliance; or
 - C. The appliance has been exposed to rain; or
 - D. The appliance does not appear to operate normally or exhibits a marked change in performance; or
 - E. The appliance has been dropped or the enclosure damaged.
17. **Servicing** – The user should not attempt to service the appliance beyond that described in the operating instructions. All other servicing should be referred to qualified service personnel.
18. **Liquid Hazards** – The appliance shall not be exposed to dripping or splashing and no objects filled with liquids, such as vases shall be placed on the appliance.

PORTABLE CART WARNING



S3125A



Precautions

1. Recording Copyright

Recording of copyrighted material for other than personal use is illegal without permission of the copyright holder.

2. Deck Location

- Do not use or leave in direct sunlight or in other places subject to high temperature and humidity. The unit should also not be left in potentially hot places such as near heating appliances. Excessive heat and moisture can lead to internal damage and serious malfunctions (this also applies to cassette tapes). The recommended ambient temperature range is 5°C to 35°C.
- Avoid damp and dusty places and locations prone to vibrations.
- Be extremely careful with the recording/playback heads. Clean and demagnetize them regularly, but under no circumstances should magnets or other metals be used anywhere near the heads.
- This unit is extremely sensitive to magnetic fields, so do not use near large speakers or other devices which generate magnetic fields.
- Hum may even be induced by magnetic flux leakage from the power transformer in certain amplifiers. Therefore, this unit should also be kept clear of the amplifier.
- Do not remove the cabinet case. If any of the internal parts are handled, there is a considerable danger of electric shock.

3. Cassettes to Avoid:

- Cassettes with poorly formed cases that rattle during rewind and fast forward.
- Low cost cassettes with no guide roller or pressure pad spring should never be used for stereo.
- C-120 cassettes because the tape and the coating are extremely thin, distortion levels are high. Also, even a slight stretching of the tape will make it susceptible to being caught up in the pinch roller and capstan.
- Endless tapes, if used for a long period of time, can overheat.

4. Care

From time to time you should wipe the front and rear panels and the cabinet with a soft cloth. For heavier dirt, dampen a soft cloth in a weak solution of mild detergent and water, wring it out dry, and wipe off the dirt. Following this, dry immediately with a clean cloth. Do not use rough material, thinners, alcohol or other chemical solvents or cloths since these could damage the finish or remove the panel lettering.

5. Power

WARNING

BEFORE PLUGGING IN THE UNIT FOR THE FIRST TIME, READ THE FOLLOWING SECTION CAREFULLY.

The voltage of the available power supply differs according to country or region. Be sure that the power supply voltage of the area where this unit will be used meets the required voltage (e.g., AC230V 50Hz or AC120V 60Hz) written on the rear panel.

For British Model

Replacement and mounting of an AC plug on the power supply cord of this unit should be performed only by qualified service personnel.

IMPORTANT:

The wires in the mains lead are coloured in accordance with the following code:

Blue: Neutral

Brown: Live

As the colours of the wires in the mains lead of this appliance may not correspond with the coloured markings identifying the terminals in your plug, proceed as follows:

The wire which is coloured BLUE must be connected to the terminal in the plug which is marked with the letter N or coloured BLACK.

The wire which is coloured BROWN must be connected to the terminal in the plug which is marked with the letter L or coloured RED.

IMPORTANT

A 5 ampere fuse is fitted in this plug. Should the fuse need to be replaced please ensure that the replacement fuse has a rating of 5 amperes and that it is approved by ASTA or BSI to BS 1362. Check for the ASTA mark or the BSI mark on the body of the fuse.

IF THE FITTED MOULDED PLUG IS UNSUITABLE FOR THE SOCKET OUTLET IN YOUR HOME THEN THE FUSE SHOULD BE REMOVED AND THE PLUG CUT OFF AND DISPOSED OF SAFELY. THERE IS A DANGER OF SEVERE ELECTRICAL SHOCK IF THE CUT OFF PLUG IS INSERTED INTO ANY 13 AMPERE SOCKET.

If in any doubt please consult a qualified electrician.

For Canadian model

NOTE:

THIS CLASS B DIGITAL APPARATUS COMPLIES WITH CANADIAN ICES-003.

For models having a power cord with a polarized plug:

CAUTION: TO PREVENT ELECTRIC SHOCK, MATCH WIDE BLADE OF PLUG TO WIDE SLOT, FULLY INSERT.

Modele pour les Canadien

REMARQUE:

CET APPAREIL NUMÉRIQUE DE LA CLASSE B EST CONFORME À LA NORME NMB-003 DU CANADA.

Sur les modèles dont la fiche est polarisée:

ATTENTION: POUR ÉVITER LES CHOCS ÉLECTRIQUES, INTRODUIRE LA LAME LA PLUS LARGE DE LA FICHE DANS LA BORNE CORRESPONDANTE DE LA PRISE ET POUSSER JUSQU'AU FOND.

Table of contents

Before Using

Checking the supplied accessories Below

Connections

Connecting to the ONKYO Separate Collection Series components 6
Connecting to other components 7

Operation

Playing a tape 9
Recording 12
CD dubbing with ONKYO Separate Collection Series 16
CD/MD/CDR Synchro Recording with ONKYO Separate
Collection Series 20

Other Information

Handling cassette tapes/Maintenance 22
Troubleshooting 23
Specifications 25
Index to parts and controls 26

Before Using

Checking the supplied accessories

Check that the following accessories are supplied with this unit.

- **RI remote control cable** × 1

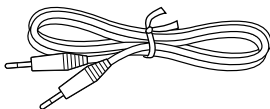

- **Audio connection cable** × 2

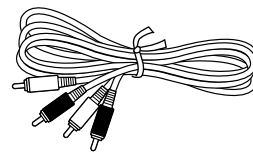
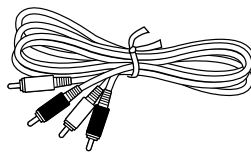

Connections

Connecting to the ONKYO Separate Collection Series components

This section introduces you to the other ONKYO Separate Collection Series system components and their convenient system functions. For the actual connecting instructions and detailed information, please refer to the Instruction Manual of the Tuner Amplifier R-801A.

The following ONKYO Separate Collection Series components are commercially available:

- C-701A Compact Disc (CD) Player (Not available in U.S.A. and Canada)
- MD-101A Minidisc (MD) Recorder (Not available in U.S.A., Canada and Europe)
- R-801A TUNER AMPLIFIER (Not available in U.S.A. and Canada)
- CDR-201A Compact Disc (CD) Recorder (Not available in U.S.A. and Canada)

Note that the available components may vary according to the area.

Combination use of the unit with the above system components enables you to operate the following convenient functions:

- **Auto Power On**
 - You can turn on the amplifier by pressing the STANDBY/ON button on one of the system components.
 - You can turn on all the system components at the same time by pressing the STANDBY/ON button on the amplifier.
 - You can turn off each component not in use independently afterwards.
- **Direct Change**

Press the following button on the component you want to operate to switch the amplifier's input selector automatically to that component:

 - The play button on the K-501A.
- **Remote Control Operation**

All the system components can be operated using the remote controller supplied with the R-801A.
- **Program Timer**

You can operate timer playback and recording using the R-801A (refer to the Instruction Manual of the R-801A).
- **Sleep Timer**

You can fall asleep to a music/radio program using the timer (refer to the Instruction Manual of the R-801A).
- **CD Dubbing**

Simple CD dubbing with this unit is possible with the pressing of a single button (see page 16).
- **CD/MD/CDR Synchro Recording**

When using this unit to record a tape from the CD player, MD recorder or CD recorder, you can start recording automatically (while the unit is in recording standby) at the same time as you start playing a CD, MD or CDR (see page 20).
- **MD/CDR Synchro Recording from this unit**

When using the MD recorder or CD recorder to record a MD or CD from this unit, you can start recording automatically at the same time as you start playing a tape.

Connecting the unit to R-801A

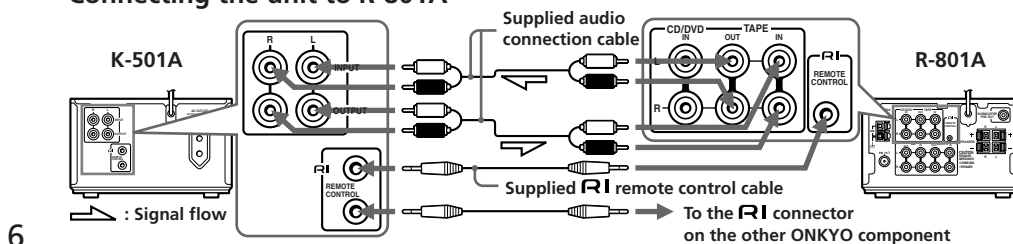

Connecting to other components

Before connecting

- Do not connect the AC power cord (mains lead) until you have completed all the other connections including the **RI** connections on the next page.
- On each pair of connectors, a red connector (marked R) corresponds to the right channel, and a white connector (marked L) to the left channel. Connect white plugs of audio connection cables to L connectors and connect red plugs of audio connection cables to R connectors .

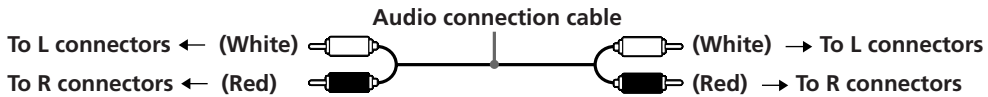

- Insert the plug securely. If the connection is incomplete, noise or malfunction may result.

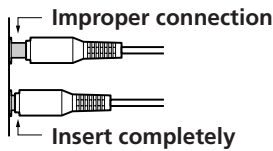

- Bundling an audio connection cable with the power cord or speaker cord may degrade the sound quality.
- To use the unit with the other ONKYO Separate Collection Series components, follow the connection diagram in the R-801A instruction manual to connect the unit to the system.

Note:

The 230-240 V model is shown in the following illustrations.

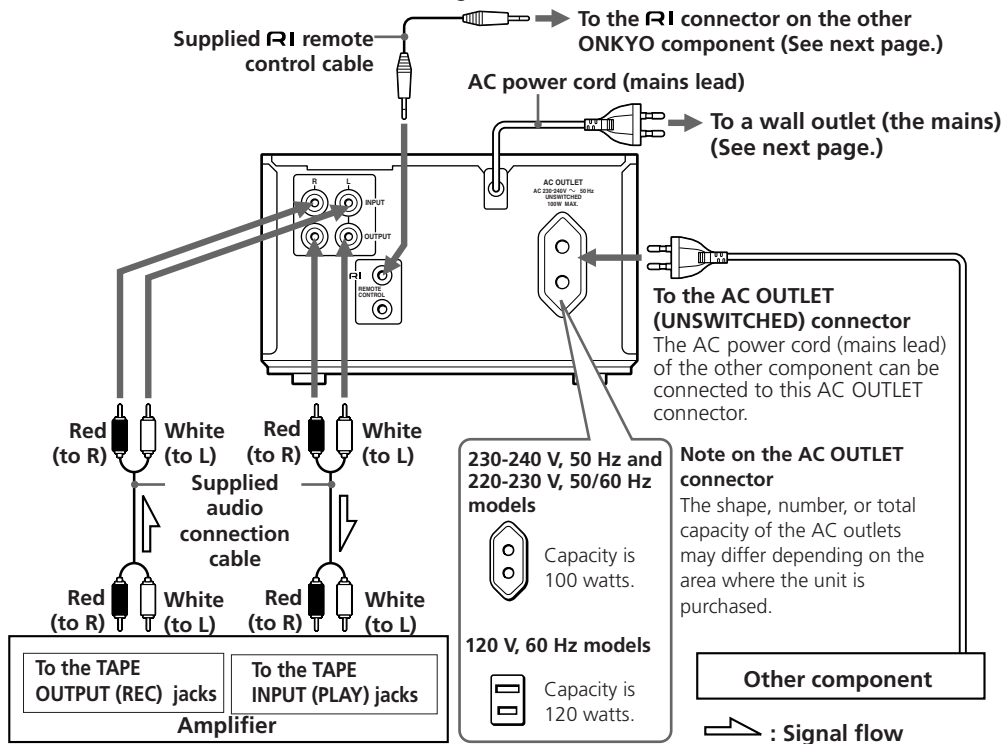

Connecting to other components (continued)

Connecting the **RI** connectors

If you are using other ONKYO components equipped with **RI** connectors, you can control these components using the amplifier's remote controller.

Before connecting

- The amplifier must be connected in the **RI** system hookups for **RI** control operations.
- Each component has two **RI** connectors. There is no difference between these connectors.
- The components may be connected in any order.
- The hookups on the previous page are necessary independently of the **RI** system hookups.

The illustration below is an example of a **RI** hookup. With these hookups, you can operate the CD Synchro Recording; when recording a tape with this unit from the CD player, you can start recording automatically (while the unit is in recording standby) at the same time as you play the CD (see "CD Synchro Recording" on page 14).

For CD Synchro Recording, at least the unit, amplifier, and CD player must be connected with the **RI** connectors.

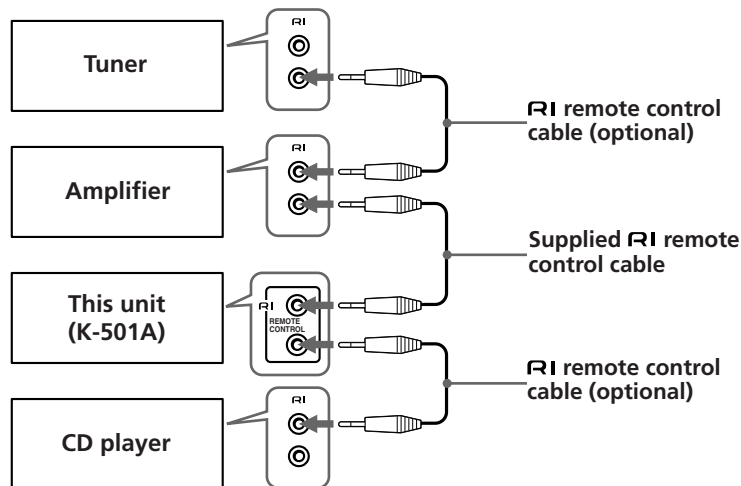

Note
An **RI** remote control cable equipped with a 1/8 in. (3.5mm) diameter miniature two-conductor phone plug is included with this unit and with every compact disc player and tuner that bears the **RI** mark.

Connecting the AC power cord (mains lead) to the wall outlet (the mains)

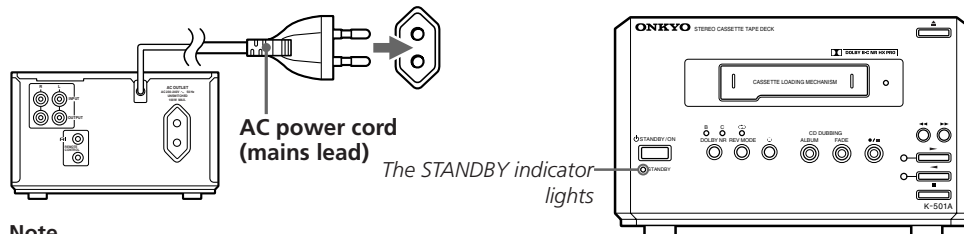

Note

If you connect the AC power cord (mains lead) to the AC outlet of another component, the component's AC power cord (mains lead) must be connected to the wall outlet (the mains) to supply power to the unit. If the component has a main power switch, it must be set to On.

Operation

Playing a tape

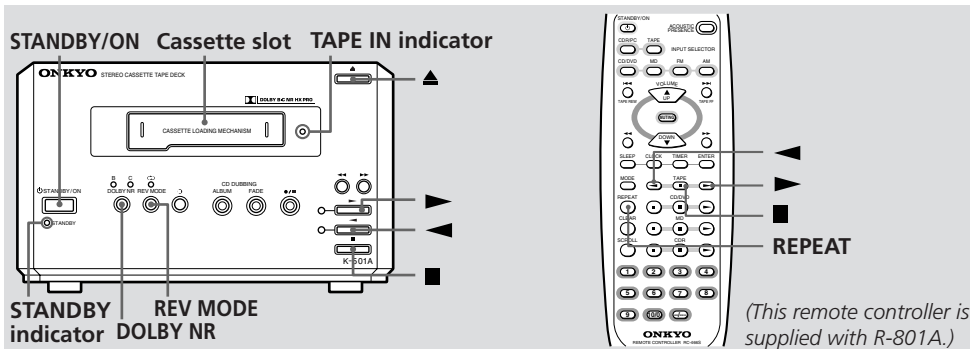

1 Insert a recorded cassette in the cassette slot with the tape side facing to the left.

The unit turns on automatically if it is in standby. (The STANDBY indicator goes off, then the TAPE IN indicator lights.)

Note

The tape side of the cassette must face to the left. Never insert it in any other direction.

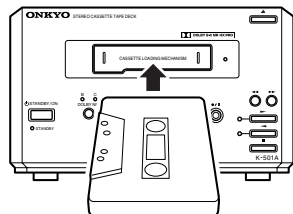

2 Press DOLBY NR until the proper indicator of the Dolby NR mode lights, matching the mode the tape is recorded in.

The indicators light in the following order:

☼ (Dolby B NR) → ⦿ (Dolby C NR)

↑ The indicator goes off. ↓

DOLBY NR



3 Press REV MODE (or REPEAT) to select the reverse mode.

Each press turns ⦿ (the REV MODE indicator) on or off.

REV MODE



- **When ⦿ is lit (Auto reverse mode)**
The unit plays both sides of the tape eight times and stops.
- **When ⦿ goes off (One-way mode)**
The unit will stop playing when the playing side of the tape reaches its end.

4 Press ► to start playback (or ◀ to play the reverse side).



Note

No sound is reproduced while the unit is rotating the playing head for reverse side playback.

To stop playback

Press ■. (Press this button to stop whatever the tape operation is.)

To eject the cassette.

Press ▲.

Connections

Operation

(Continued on the next page) 9

Playing a tape (continued)

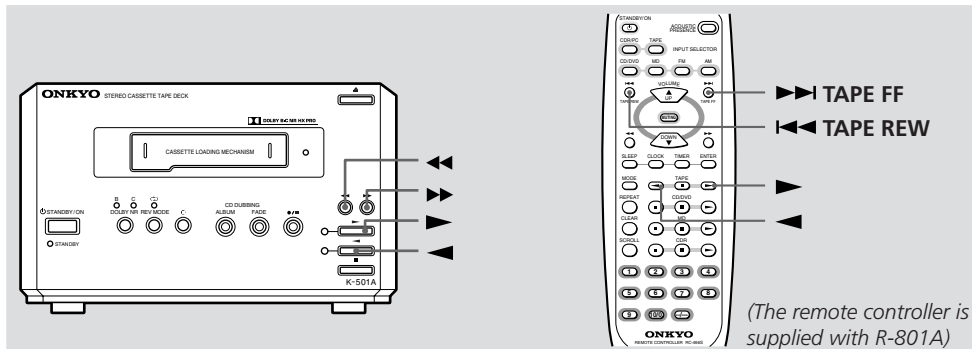

Starting playback in other ways – One-touch playback

Press ► to start playback (or ◀ to play the reverse side) after step **1** on the previous page, then playback will start.

If the cassette is already in the unit

Simply press ► to start playback (or ◀ to play the reverse side).

- The unit turns on automatically if it is in standby.
- If the unit is connected to the R-801A with the **RI** connectors, both the unit and R-801A turn on automatically.

Fast-forwarding the tape

When the following PLAY indicator is lit	While the tape is stopped, press
	►► (or ►► TAPES FF)
	◀◀ (or ◀◀ TAPES REW)

Rewinding the tape

When the following PLAY indicator is lit	While the tape is stopped, press
	◀◀ (or ◀◀ TAPES REW)
	►► (or ►► TAPES FF)

About Automatic Tape Type Detection

The unit automatically detects the type of the cassette, NORMAL (TYPE I), HIGH (TYPE II), or METAL TAPE (TYPE IV), and conforms to the tape type. The unit identifies the tape type by means of the detection holes of the cassette (see the illustration in "Preventing an accidental recording" on page 15).

Notes

- Automatic Tape Type Detection doesn't operate, if:
 - one or both of the detection holes are covered (e.g. with adhesive tape), or
 - the cassette doesn't meet this tape standard.

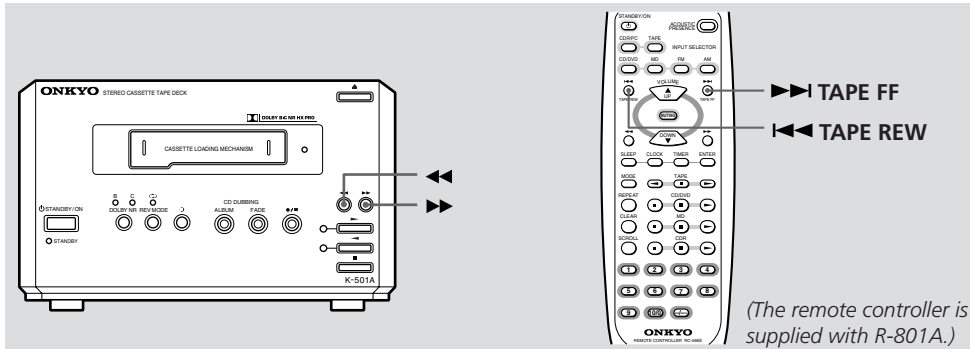

Skipping to the track you want to listen to during playback – Skip Play

Playing the currently-playing track from the beginning

When the following PLAY indicator is lit	During playback, press
	◀◀ (or ◀◀◀ TAPE REW)
	▶▶ (or ▶▶▶ TAPE FF)

Skipping to the next track during playback

When the following PLAY indicator is lit	During playback, press
	▶▶ (or ▶▶▶ TAPE FF)
	◀◀ (or ◀◀◀ TAPE REW)

Notes

- If you press ▶▶ (or ▶▶▶ TAPE FF) or ◀◀ (or ◀◀◀ TAPE REW) during playback, the unit will go to the beginning of the track by locating the blank section between tracks. The PLAY indicator flashes in the direction in which the tape is running while the unit is locating the beginning of the track after the button is pressed.
- To fast forward, press ▶▶ (or ▶▶▶ TAPE FF) again while the unit is locating the beginning of the track. To rewind, press ◀◀ (or ◀◀◀ TAPE REW).
- The unit recognizes the position of the track from the current one by blank sections between tracks. Therefore, it may not operate properly, if:
 - the blank section between the tracks is too short,
 - the music is intermittent, or the recording is not music (e.g. narration),
 - the blank section is filled with excessive noise, or
 - a small sound suddenly follows a loud sound (in this case, the unit might recognize the small sound section as blank by mistake).

Operation

Recording

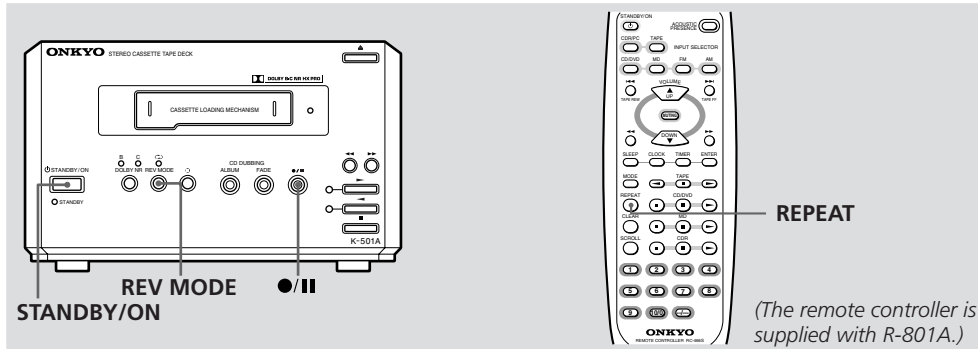

Before starting

The shadowed steps are operations with the other components.

1 Press STANDBY/ON, if the unit is not turned on.



2 Insert a cassette with its erasure prevention tabs in place, following step 1 in "Playing a tape" on page 9.

See "Preventing an accidental recording" on page 15.

3 Press REV MODE (or REPEAT) to select the reverse mode.

Each press turns  (the REV MODE indicator) on or off.



- **When  is lit (Auto reverse mode)**

The unit records both sides of the tape and stops.

Note

If you start recording on the reverse side of the tape in step **10**, the unit will record only the reverse side and then stop, even if the reverse mode is set to the Auto reverse mode.

- **When  goes off (One-way mode)**

The unit stops after recording one side of the tape.

4 Prepare the source component you want to record from.

- **Tuner**

Tune into the station you want to record.

- **CD player/MD recorder/CD recorder**

Insert a CD (MD) into the CD player/CD recorder (MD recorder).

- **Cassette tape deck/DAT**

Insert a recorded cassette into the cassette tape deck or DAT.

5 Select the component you prepared in the above step with the input selector on the amplifier.

6 Press to put the unit in recording pause.

The REC indicator around the button lights.



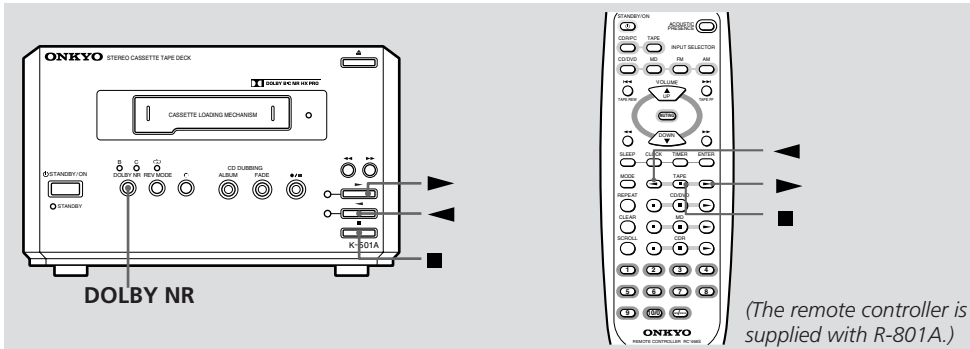
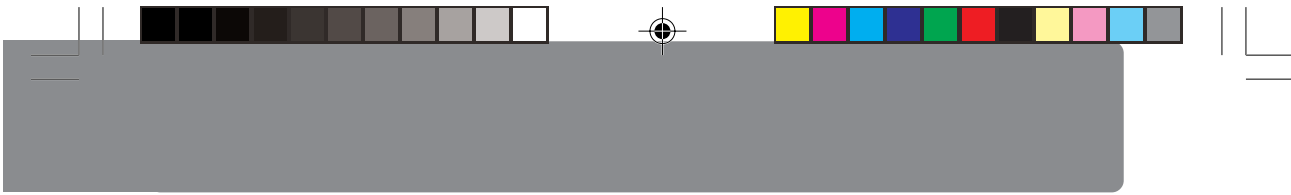

7 Press DOLBY NR until the indicator of the Dolby NR mode you want to record with lights.

See "Dolby Noise Reduction Systems" on page 15 for Dolby NR mode information. The indicators light in the following order:

☀ (Dolby B NR) → ⦿ (Dolby C NR)

↑ The indicator goes off. ↓



10 Start playing the source.

To stop recording

Press ■.

The REC indicator around the button goes off.

8 Set the source component to start playing at the point you want to start recording from.

9 Press ► to start recording (or ◀ to record on the reverse side).

The PLAY indicator becomes brighter. Let the tape run for a while if you are starting recording from the beginning of the tape. This is because no sound will be recorded on the leader.

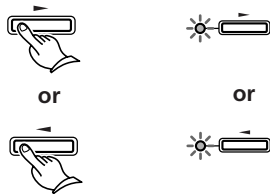

(Continued on the next page) 13

Recording (continued)

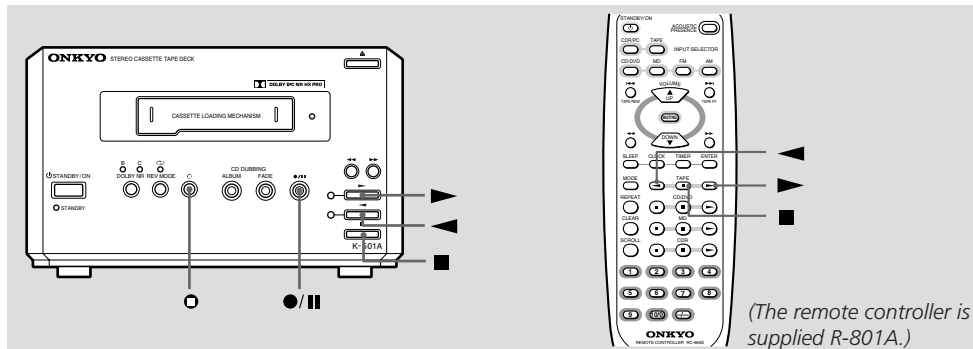

Inserting a blank section between tracks – Auto Space

To use Skip Play on page 11, there must be sufficient blank sections between tracks. If the recording source doesn't have enough blank sections between tracks, or if you are recording from various sources onto one tape, you need to make proper blank sections between tracks.

1 While recording or recording pause, press **○** at the point when one track has finished.

Pause the playing source at the same time.

After the unit has completed making a blank section of about five seconds, it enters recording pause automatically.



2 Press **▶** or **◀** (the button corresponds to the indicator lighted) to restart recording. Restart playing the source at the same time.

To make the blank section less than five seconds

Press **●/||** to enter the unit into recording pause, before five seconds elapse after you press **○** in step 1 above.

To make the blank section longer than five seconds

Press and hold **○** in step 1 above until the desired time has elapsed. The unit enters recording pause immediately after you release the button.

CD Synchro Recording

The **RI** hookups are necessary for these operations. See "Connecting to the **RI** connectors" on page 8.

Operations

The operations for CD Synchro Recording are almost the same as the recording operations starting from page 12.

The differences are follows:

- Skip step 9 and go to step 10. When you start playing the CD in step 10, CD recording will start at the same time.
- Recording starts in the direction retained in the unit memory in step 9. If the tape side you want to record on doesn't match the tape transport direction, press and hold **●/||**, then press **▶** or **◀** to change the starting direction in step 6. The REC and PLAY indicators light.

To interrupt CD Synchro Recording

- If you press **■** on the CD player to stop the CD, the unit will stop recording and enter recording pause. The REC indicator goes off.

Note

If you press ■, the unit will stop recording, but the CD player will continue playing. If you press ■ on the C-701A before pressing ■ on the unit, the unit will enter recording pause.

Additional information for recording

Dolby Noise Reduction Systems

Dolby NR (Noise Reduction) systems are to reduce background hiss noise on the tape, and applied to all types of cassettes.

This unit is equipped with the Dolby B NR and Dolby C NR systems.

- Dolby B NR is most commonly applied to commercially available stereo cassette tape decks.
- Dolby C NR was further developed from Dolby B NR to satisfy the demand for wider dynamic range sound reproduction, and is more effective in reducing tape noise than Dolby B NR.

It is recommended that a note be made on the cassette label as to which Dolby NR mode the tape was recorded in, since the tape must be played in the same Dolby NR mode.

Dolby HX Pro System

The unit is also equipped with the Dolby HX Pro system.

Dolby HX Pro is a system that constantly adjusts the recording bias current to the most suitable level. With this system, even music sources consisting mostly of high frequency sounds can be recorded in good condition because the dynamic range in higher frequencies can be expanded.

The system operates while recording regardless of the Dolby NR mode setting.

Preventing an accidental recording

- Cassettes have two erasure prevention tabs; one is for side A and the other is for side B as you see in the illustration below. By removing one or both of the tabs, you can prevent accidental recording over the recorded tape.
- After you remove the erasure prevention tabs, you can cover them with adhesive tape for recording. When you do this, avoid covering the tape type detection holes (see "About Automatic Tape Type Detection" on page 10).

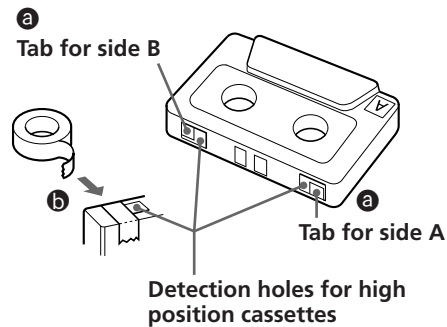

CD dubbing with ONKYO Separate Collection Series

K-501A (This unit)

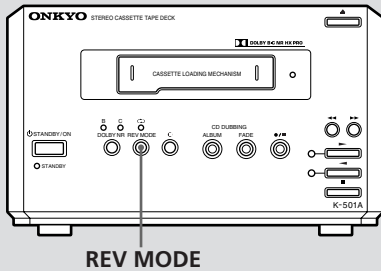

R-801A (Tuner Amplifier)

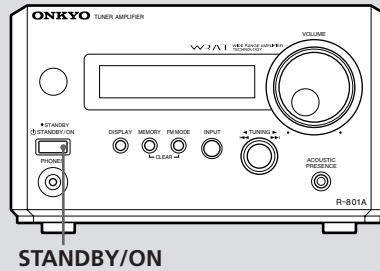

The unit must be connected to R-801A (Tuner Amplifier) and C-701A (CD Player) for these operations. (See "Connecting to the ONKYO Separate Collection Series components" on page 6.)

For CD dubbing, the following two modes are provided:

- **ALBUM (Album dubbing)**

If a track is not completely recorded because the end of the tape was reached during CD dubbing, the unit will rewind the tape to the beginning of the incompletely recorded track and erase it. If the unit is in the Auto reverse mode, it will continue recording on the other side of the tape starting from the erased track.

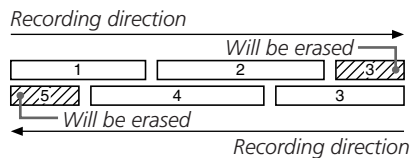

- **FADE OUT (Fade out dubbing)**

If a track is not completely recorded because the end of the tape was reached during CD dubbing, the unit will fade it out. If the unit is in the Auto reverse mode, it will continue recording on the other side of the tape starting from the beginning of the track that was faded out.

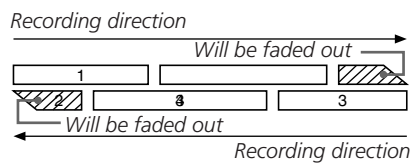

Before starting

The shadowed steps are the operations with the CD player or amplifier.

1 Press STANDBY/ON on the amplifier, if the unit is not turned on.

All the system components will be turned on.



2 Insert a cassette with its erasure prevention tabs in place, following step 1 in "Playing a tape" on page 9.

See "Preventing an accidental recording" on page 15.

Be sure to lay the recording side of the cassette face up.

3 Press REV MODE to select the reverse mode.

Each press turns \odot (the REV MODE indicator) on or off.



- **When \odot is lit (Auto reverse mode)**

The unit records both sides of the tape and stops.

K-501A (This unit)

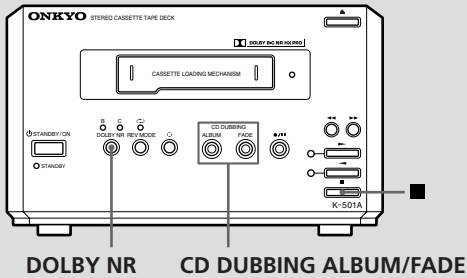

C-701A (CD player)

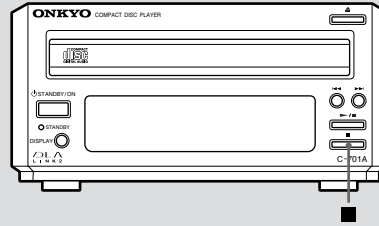

- When goes off (One-way mode) The unit stops after recording the forwarding side of the tape.

- When CD DUBBING ALBUM or CD DUBBING FADE is pressed, the unit adjusts the recording level to its optimum level and starts to rewind the tape. To avoid the leader (the transparent section at both ends of the tape where no sound can be recorded), the unit makes a blank section 10 seconds long at the beginning of both A and B sides. Do not press any button until the unit or C-701A has completed this operation.
- The PLAY indicator flashes while the unit is making the blank section and lights when it starts recording.

4 Insert a CD into the CD player.

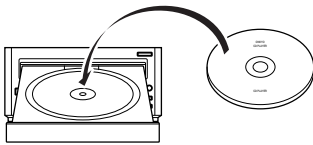

5 Press DOLBY NR until the indicator of the Dolby NR mode you want to record with lights.

See "Dolby Noise Reduction Systems" on page 15 for Dolby NR mode information. The indicators light in the following order:

(Dolby B NR) → (Dolby C NR)
 ↑ The indicator goes off. ↓



6 Press CD DUBBING ALBUM for Album dubbing or CD DUBBING FADE for Fade out dubbing.

The CD DUBBING ALBUM or CD DUBBING FADE indicator around the each buttons lights.



Note

- If the CD or tape is not inserted correctly or all operations on the unit and C-701A have not stopped, the CD DUBBING ALBUM or CD DUBBING FADE indicator flashes and recording will not begin.
- If a track is too long to fit on one side of the tape, it will continue to be recorded from side A onto side B without being erased.
- Fade out may not be completed if the leader is encountered.
- No sound will be recorded if less than about 30 seconds remains on the end of the tape.

To stop CD dubbing

Press on the unit or CD player.

(Continued on the next page) 17

CD dubbing with ONKYO Separate Collection Series (continued)

K-501A (This unit)

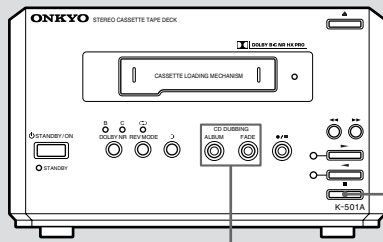

CD DUBBING ALBUM/FADE

C-701A (CD player)

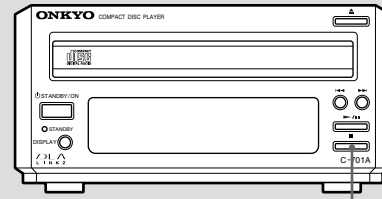

Dubbing from more than two CDs continuously - *Continuous Dubbing*

Before starting

The shadowed steps are operations with the CD player or amplifier.

1 Follow steps 1 to 6 starting from page 16.

2 Press ■ on the unit or CD player, at the point when the track you are dubbing is finished.

CD dubbing stops.



Note

Do not touch any buttons on the unit after CD dubbing stops, otherwise Continuous Dubbing will be cancelled.

3 Replace the CD with the next one.

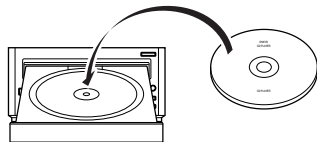

4 Press CD DUBBING ALBUM for Album dubbing or CD DUBBING FADE for Fade out dubbing.

The unit makes a blank section of about 5 seconds and starts dubbing without rewinding the tape.



K-501A (This unit)

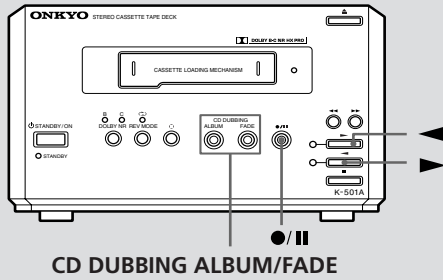

Starting dubbing CD without rewinding the tape

1 Follow steps 1 to 5 starting from page 16.

2 Press ●/||.

The REC indicator around the button lights.
The unit is set to recording pause.



To change the recording direction

Press ► or ◀ while pressing ●/||.

3 Press CD DUBBING ALBUM for Album dubbing or CD DUBBING FADE for Fade out dubbing.

The CD DUBBING ALBUM or CD DUBBING FADE indicator around the each buttons lights.

The unit makes a blank section of about 5 seconds and starts dubbing without rewinding the tape.



CD/MD/CDR Synchro Recording with ONKYO Separate Collection Series

K-501A (This unit)

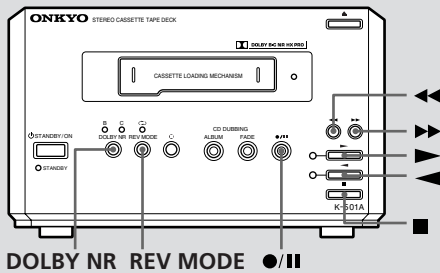

C-701A (CD player) is used for the illustration example.

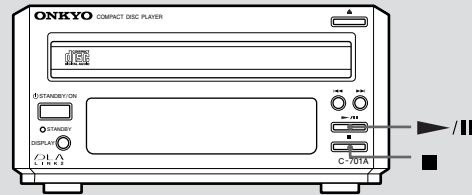

Before starting

The shadowed steps are operations with the CD player, MD recorder, CD recorder, or amplifier. The unit must be connected to R-801A, and C-701A (CD Player), MD-101A (MD recorder) or CDR-201A (CD recorder) for these operations. (See "Connecting to the ONKYO Separate Collection Series components" on page 6.)

1 Press STANDBY/ON on the amplifier, if the unit is not turned on.

All the system components will be turned on.



2 Insert a cassette with its erasure prevention tabs in place, following step 1 in "Playing a tape" on page 9.

See "Preventing an accidental recording" on page 15.



Note

If you start recording the tape from the beginning, wind the tape slightly forward with a pencil (see page 22 for illustration) before inserting the cassette. This is because the sound cannot be recorded on the leader.

3 Press REV MODE to select the reverse mode.

Each press turns  (the REV MODE indicator) on or off.

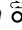

- **When  is lit (Auto reverse mode)**
The unit records both sides of the tape and stops.
- **When  goes off (One-way mode)**
The unit stops after recording one side of the tape.

4 Insert a CD (MD) into the CD player or CD recorder (MD recorder), and start playing for recording adjustment.

e.g. Insert a CD into the CD player.

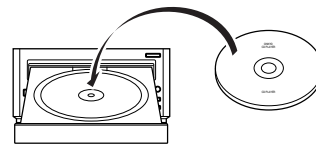

5 Press and hold ●/II, then press ► or ◀ (to record on the reverse side) to decide the recording direction.

The REC indicator around the button and PLAY indicator light.
The unit is set to recording pause.

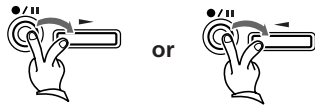

6 Press DOLBY NR until the indicator of the Dolby NR mode you want to record with lights.

See "Dolby Noise Reduction Systems" on page 15 for Dolby NR mode information.
The indicators light in the following order:

☼ (Dolby B NR) → ⦿ (Dolby C NR)

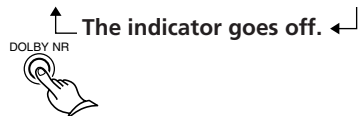

7 Set the CD player, MD recorder or CD recorder to start playing at the point you want to start recording from.

8 Press ►/II on the CD player, MD recorder or CD recorder.



To stop recording

Press ■ on the unit. (The CD player, MD recorder or CD recorder continues playing.)

Note

If you press ■ on the CD player, MD recorder or CD recorder before pressing ■ on the unit, the unit makes a blank section of about 5 seconds and enters recording pause.

Precautions regarding the recording level

If you are dubbing with the unit connected to the FR series (FR-X7, FR-V77, FR-V7, FR-V5, FR-V3, FR-435, FR-155), or a tuner or cassette deck of the Separate Collection Series, the recording level will be set lower. (This is the default setting.)

To set the recording level higher

- 1 Press STANDBY/ON to return the unit to standby mode.
- 2 Press DOLBY NR and ►► simultaneously. (The CD DUBBING ALBUM, CD DUBBING FADE and REC indicators will light. Setting is completed.)

To return to the default setting level

- 1 Press STANDBY/ON to return the unit to standby mode.
- 2 Press DOLBY NR and ◀◀ simultaneously. (The ⦿, ⦿, and ⦿ indicators will light. Setting is completed.)

You can also return to the default recording level by removing the power plug from the outlet and then plugging it in again.

Synchro recording from K-501A to MD-101A or CDR-201A

When you start playback on the K-501A when the MD-101A or CDR-201A is set to recording pause, the input source of the R-801A turns automatically to TAPE and synchro recording starts from the K-501A to the MD-101A or CDR-201A.

To adjust the recording level and start synchro recording

Start playback on the unit and adjust the recording level by referring to "Analog recording" in the Instruction Manual of the MD-101A or CDR-201A.

Then, rewind to the point you want to start recording from and start playback again on the unit. Synchro recording starts.

To stop recording

Press ■ on the unit.



Other Information

Handling cassette tapes/Maintenance

If the tape is loose and hanging out of the cassette

If you try to play the cassette when the tape is loose and hanging out, the tape won't be picked up properly between the capstan and the pinch roller and may be jammed inside, this will result in damage to the tape. Tighten the loose tape as shown in the illustration below.

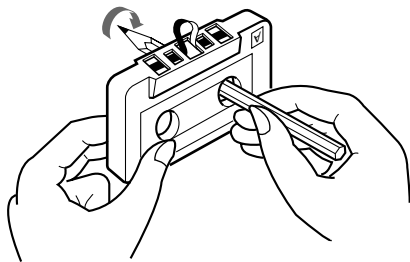

Caution

- Do not touch the tape surface.
- Do not put thick paper or cardboard labels in the cassette holder.
- Do not put cassettes near magnetic sources like speakers, amplifiers, TVs, etc. Your important recording might be erased or damaged.
- Do not expose cassettes to direct sunlight.

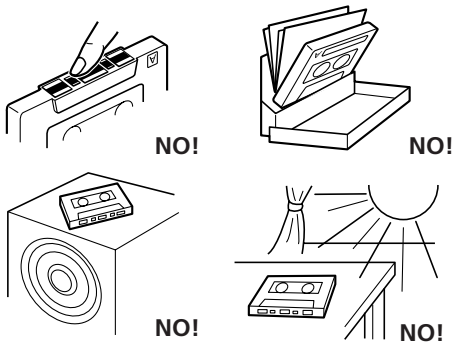

Cassettes not recommended

- **C120 cassettes**
C120 tape is thin and therefore more liable to break. There is a possibility that tape could get caught in the pinch roller or capstan.
- **Continuous loop (endless) tapes**
Do not use continuous loop (endless) tapes.

Cleaning the tape heads

Clean the (recording/playback/erasure) heads, capstan, and pinch roller before recording/playing in order to enjoy the best sound. Normally clean it at least after every ten hours of use.

Use a commercially available head cleaning cassette.

Refer to the operation manual of the head cleaning cassette for details.

Caution

- Turn the amplifier volume down to the minimum before cleaning.
- Wait a few minutes after cleaning until the heads are completely dried before inserting a cassette.

De-magnetizing the tape heads

When the cassette deck is used for a long time, magnetism will build up on the head. This causes noise or a loss of high sound range on important recorded tapes. De-magnetize the head after every 50 hours of use with a commercial de-magnetizer suited to this cassette deck. Refer to the operation manual of the de-magnetizer for details.

Caution

Turn the amplifier volume down to the minimum before de-magnetizing.



Troubleshooting

If you have any problems with the unit, please check the troubleshooting table below first. For any problems not covered in the table, please consult your nearest ONKYO authorized service center.

Symptom	Cause	Remedy
The unit doesn't turn on.	<ul style="list-style-type: none"> The AC power cord is not inserted in the wall outlet securely. 	<ul style="list-style-type: none"> Insert the AC power cord (mains lead) plug into the wall outlet (the mains) securely.
No sound is heard even when playback starts.	<ul style="list-style-type: none"> Hookups are incorrect. The stereo amplifier's input selector is set to the wrong position. 	<ul style="list-style-type: none"> Check the hookup and connect the unit correctly (see page 7). Set the amplifier's input selector to the position the unit is connected to.
Tape transport doesn't operate.	A slack tape is wound around the pinch roller.	Tighten the tape with a pencil (see previous page).
The REC button doesn't operate.	<ul style="list-style-type: none"> No cassette is inserted in the unit. One or both of the erasure prevention tabs have been removed. 	<ul style="list-style-type: none"> Insert a cassette (see page 9). Use a new cassette or cover the erasure prevention tabs with adhesive tape (see page 15).
Sound is hoarse, or the left and right sounds are unbalanced.	<ul style="list-style-type: none"> The playback head is dirty. The tape is stretched. 	<ul style="list-style-type: none"> Clean the tape head (see previous page). Use a new cassette.
Excessive tape hiss or noise is heard.	<ul style="list-style-type: none"> The playback head is magnetized. The tape is worn out or recorded with high noise level. 	<ul style="list-style-type: none"> Demagnetize the head (see previous page). Use a new cassette.
Sound is distorted.	The tape is worn out, or distorted sound is recorded.	Use a new tape. (Play another tape to make sure the cause is not malfunction of the unit.)
Recorded sounds are distorted.	The tape was recorded with too high a recording level.	Adjust the recording level (see page 21) before you start recording.
The tape squeals or skips the sound.	<ul style="list-style-type: none"> The heads, pinch rollers, or capstan shafts are dirty. The cassette shell is binding the tape or the tape is stretched. 	<ul style="list-style-type: none"> Clean the tape head (see previous page). Try to release the bound tape by fast-forwarding and rewinding. If the tape is damaged, use a new cassette.
Excessive hum is heard while playing a tape.	<ul style="list-style-type: none"> The audio cables are not inserted firmly. External flux leakage from an amplifier or TV set is affecting to the sound. 	<ul style="list-style-type: none"> Insert the cable plugs firmly. Put more distance between the unit and appliance affecting to the unit.

(Continued on the next page)

Troubleshooting (continued)

Symptom	Cause	Remedy
High frequencies are too strong.	<ul style="list-style-type: none"> The Dolby NR mode setting is not matched to the one the tape was recorded with. Automatic tape-type detection is not operating properly. 	<ul style="list-style-type: none"> Set the proper Dolby NR mode (see pages 9 and 15) before you start playing the tape. Check the detection holes are not covered, and that you are using a cassette which meets the tape standard (see page 10).
No high frequency sounds are heard.	<ul style="list-style-type: none"> The Dolby NR mode setting is not matched to the one the tape was recorded with. The tape head is dirty. 	<ul style="list-style-type: none"> Set the proper Dolby NR mode (see pages 9 and 15) before you start playing the tape. Clean the tape head (see page 22).
The skip function doesn't operate properly.	The blank section between tracks is too short or noisy.	Insert the blank section properly (see page 14).
Auto Reverse doesn't operate properly.	<ul style="list-style-type: none"> The reverse mode is not set to the Auto reverse mode. The cassette has no leader or the leader is not transparent. 	<ul style="list-style-type: none"> Set the Auto reverse mode (see page 9). Use a cassette with suitable leader.
Auto Reverse operates even though the tape has not reached the end.	The tape is creased, wrinkled, or scratched.	<ul style="list-style-type: none"> Use a new cassette. Set the One-way mode (see page 9).
The STANDBY indicator flashes quickly, and no buttons operate.	There is a malfunction of the unit.	Remove the power plug from the outlet and then plug it in again. If not recovered, consult your nearest ONKYO authorized service center.
The unit doesn't operate properly.	The internal microcomputer of the unit is being affected by the power supply or static electricity.	<p>Turn off the unit for more than ten seconds, and turn it on again.</p> <p>If the unit still remains inoperable, disconnect the AC power cord (mains lead) from the wall outlet (the mains) and connect it again.</p>



Specifications

Track format

4-tracks, 2-channels

Erasing system

AC erase

Tape speed

4.8 cm/sec.

Wow and flutter

0.1 % (WRMS)

0.2 % (DIN)

Frequency response

Metal position tape

30 to 15,000 Hz \pm 3 dB

High position tape

30 to 14,000 Hz \pm 3 dB

Normal position tape

30 to 13,000 Hz \pm 3 dB

Signal to noise ratio

- 54 dB (metal position tape, Dolby NR off)
- Noise reduction of 10 dB above 5 kHz and 5 dB at 1 kHz is possible with Dolby B NR.
- Noise reduction of 20 dB at 5 kHz is possible with Dolby C NR.

Input Jacks

LINE IN: 2

Input sensitivity: 500 mV

Input impedance: 50 kohms

Output Jacks

LINE OUT: 2

Standard output level: 500 mV

Output load impedance:

over 50 kohms

Motors

DC servo motor: 1

Heads

REC/PB: Special Hard Permalloy: 1

Erase head: Ferrite: 1

Power supply rating

AC 230-240 V, 50 Hz

AC 220-230 V, 50/60 Hz

AC 120 V, 60 Hz

Power consumption

13 W (230-240 V, 50 Hz)

(220-230 V, 50/60 Hz)

14 W (120 V, 60 Hz)

Dimensions (W \times H \times D)

155 mm \times 94 mm \times 303 mm

6-1/8" \times 3-11/16" \times 11-15/16"

(AC 230-240 V, 50Hz)

(AC 220-230 V, 50/60Hz)

155 mm \times 94 mm \times 297.5 mm

6-1/8" \times 3-11/16" \times 11-11/16"

(AC 120 V, 60Hz)

Weight

2.5 kg, 5.5 lbs

Specifications and external appearance are subject to change without notice as a result of product improvement.

Index to parts and controls

For operational instructions, refer to the page indicated in square parentheses.

Front panel

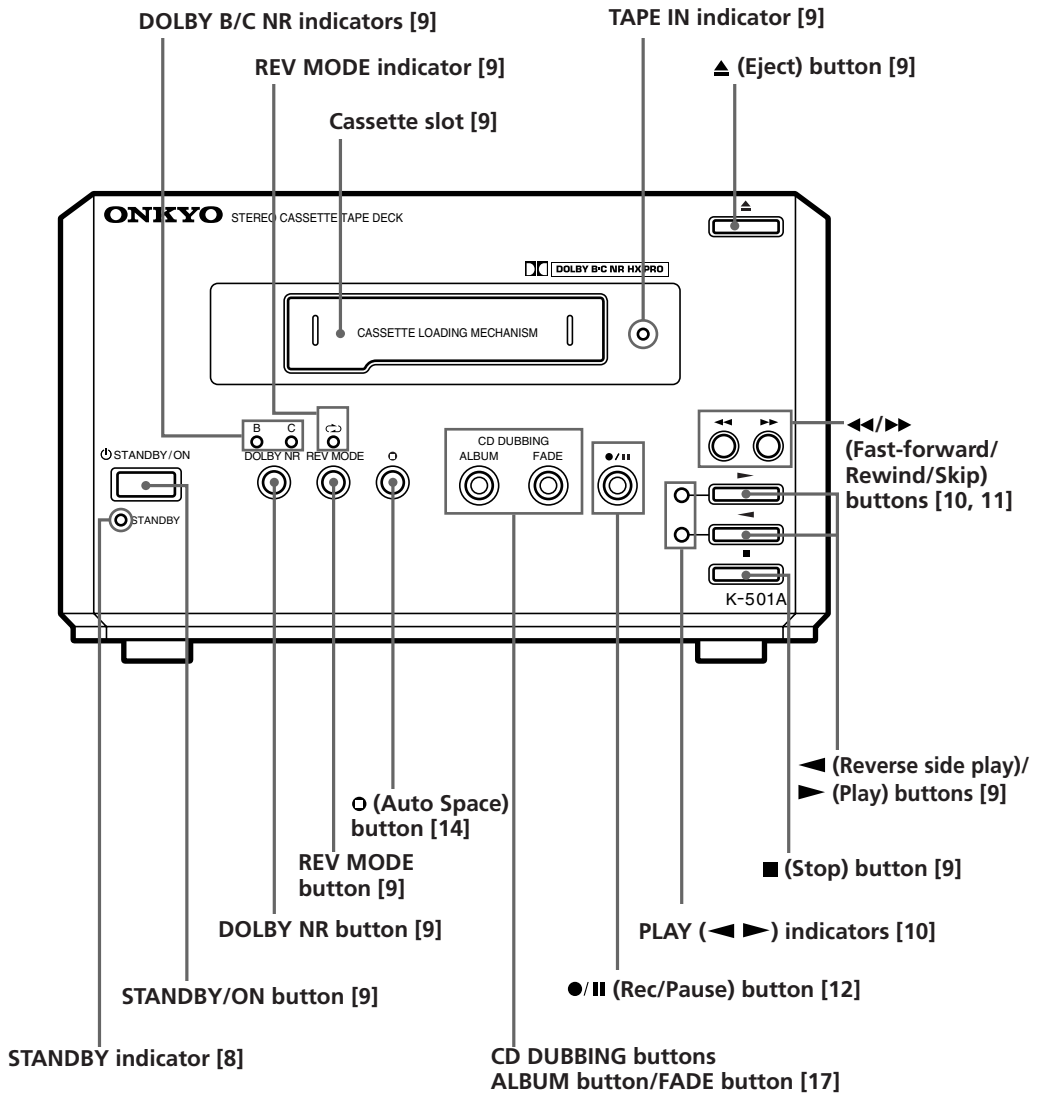

Remote controller supplied with the R-801A (RC-466S).

To operate the supplied remote controller, make the appropriate connection to the **RI** remote connectors.

Remote controller

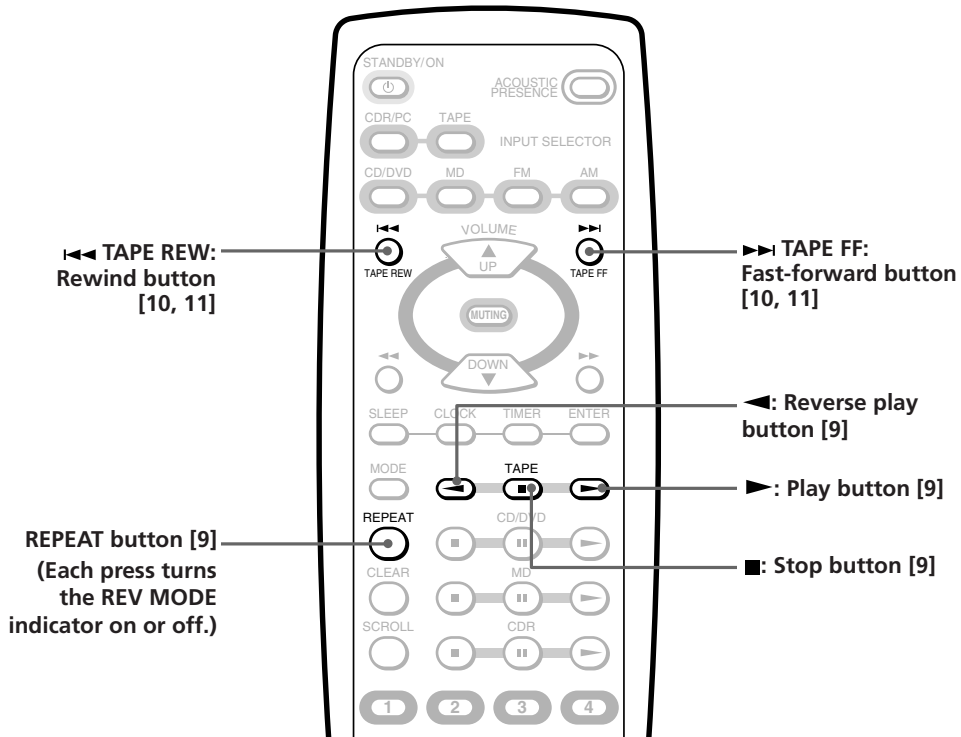



ONKYO CORPORATION

Sales & Product Planning Div. : 2-1, Nisshin-cho, Neyagawa-shi, OSAKA 572-8540, JAPAN
Tel: 072-831-8111 Fax: 072-833-5222

ONKYO U.S.A. CORPORATION

18 Park Way, Upper Saddle River, N.J. 07458, U.S.A.
Tel: 201-785-2600 Fax: 201-785-2650 <http://www.onkyousa.com>

ONKYO EUROPE ELECTRONICS GmbH

Industriestrasse 20, 82110 Germering, GERMANY
Tel: 089-849-320 Fax: 089-849-3265 E-mail: info@onkyo.de

ONKYO CHINA LIMITED

Units 2102-2107, Metroplaza Tower I, 223 Hing Fong Road, Kwai Chung,
N.T., HONG KONG Tel: 852-2429-3118 Fax: 852-2428-9039



SN 29343267

Printed in Japan
T0110-1

